

HOTEL MAP

MAIN LOBBY LEVEL

- Main Reception
- Bell Desk
- Concierge Desk
- Ski Valet
- Fairview Dining Room
- Tom Wilson Steakhouse
- Alpine Room
- Walliser Stube Wine Bar
- Chateau Deli
- Lakeview Lounge
- Children's Playroom
- The Guides Cabin
- Shops

LOWER LOBBY LEVEL

- Escape Spa and Salon
- Glacier Saloon
- Poppy Brasserie
- Shops
- Access to Lake

UPPER LOBBY LEVEL

- Larch Lounge
- Pipestone Room

FIRST FLOOR

- Victoria Room
- Pool and Fitness Centre
- Louise Meeting Room
- Agnes Meeting Room
- Lefroy Meeting Room

MOUNT TEMPLE WING

LEVEL 2

- Mount Temple Ballroom
- Guest Rooms 2929-2937
- (Accessible from East Elevators only)

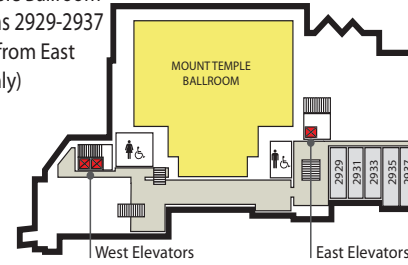

LOBBY

- Tom Wilson Steakhouse
- Guest Rooms 1929-1937
- (Accessible from West Elevators only) (Accessible from East Elevators only)
- Ice Machine

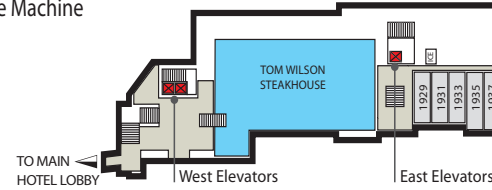

LOWER LOBBY

- Business Centre (1)
- Conference Services (2)
- Beehive Room (3)
- Lakeshore Room (4)
- Plain of Six Glaciers Room (5)
- Saddleback Room (6)

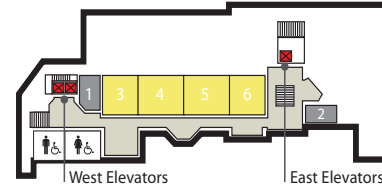

LEVEL 6

- Guest Rooms 6921-6942
- (Accessible via 5th floor from East Elevators only)
- Ice Machine

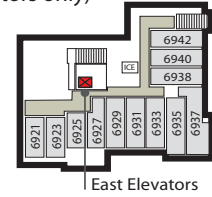

LEVEL 5

- Guest Rooms 5901-5942
- Ice Machine

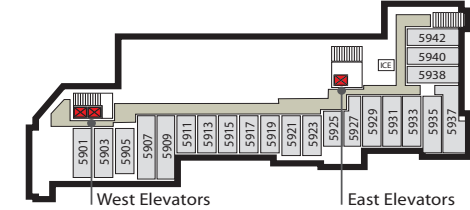

LEVEL 4

- Guest Rooms 4901-4942
- Ice Machine

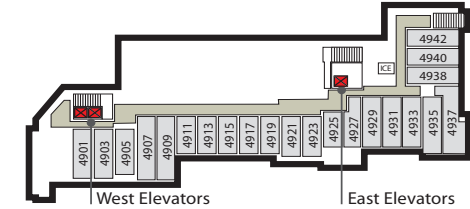

LEVEL 3

- Parker Room (A)
- Mollison Room (B)
- Guest Rooms 3901-3942
- Ice Machine

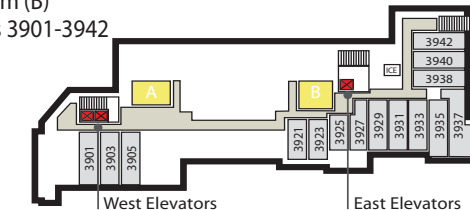

FAIRMONT
Gold
7th Floor Access

- DINING & LOUNGES
- SHOPS & BOUTIQUES
- HOTEL SERVICES
- MEETING & CONVENTION SERVICES
- GUEST ROOMS & PUBLIC SPACES
- ELEVATORS